

GF7 Zinc Die Cast Flat Hinge

Features

- Low profile design with concealed fixing on the leaf into two tapped bosses
- Securing plate and rubber gaskets, allow a panel to be held securely without damage or fracture
- Ideal for top-hinged windows and hatches
- Window glass or hatch panel is clamped between hinge leaf and securing plate
- Hinge 'butt' is plant-on fitting through two countersunk hole
- Hinge opening angle 160° forward

Material

- Body: Zinc die cast, black powder coated or chromium plated
- Pin: Stainless steel
- Gasket: Rubber
- Spacer (on leaf / securing plate): Nylon

Product Performance

- Max. axial loading: 2,860 N (ultimate loading: 4,300 N)
- Max. radial loading: 2,800 N (ultimate loading: 4,200 N)



GF7-G00699
(black)

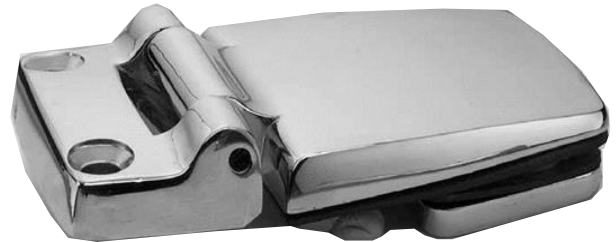

GF7-G00700
(chromium plated)

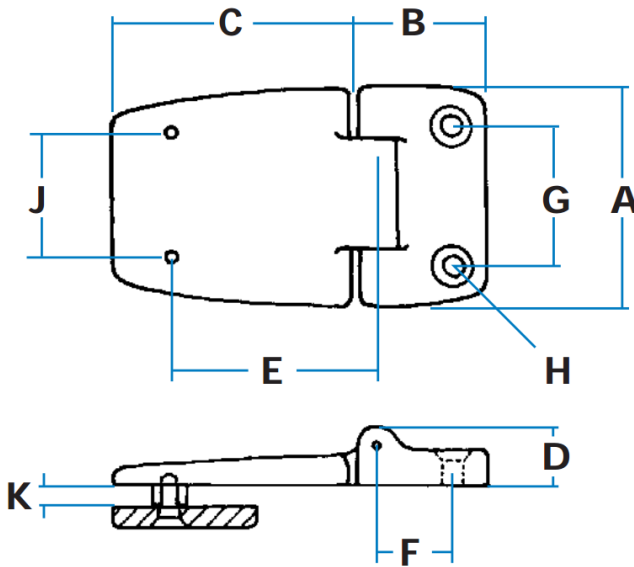

Part No.	Finish	A	B	C	D	E	F	G	H	J	K
GF7-G00699	Black Powder Coated	62	36	70	18	60	23	43	6 mm, c/s 12 mm	38	6
GF7-G00700	Chromium Plated										